

FRONT

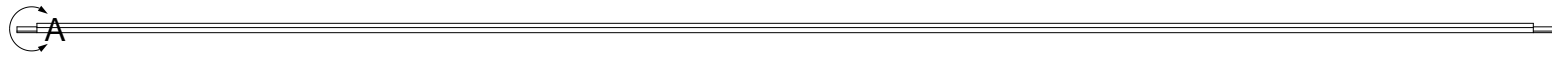

TOP

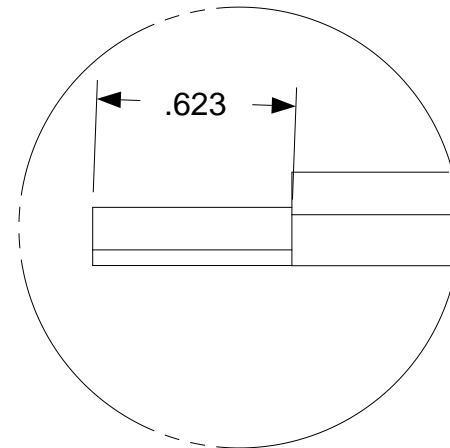
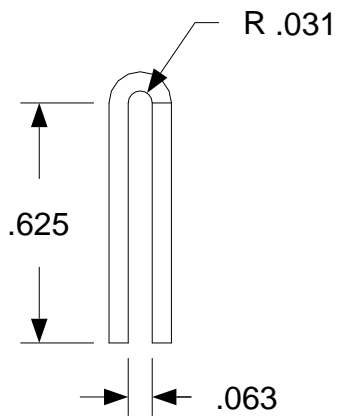

DESCRIPTION - NOTES

Make 5 attached to inside edge of vanes  
with stainless rivets every 6"

SIZE	DATE	DWG NAME	REV
A	6/24/09	inside edge reinforcing hem.icd	
SCALE	drawn by Larry Dobson		SHEET

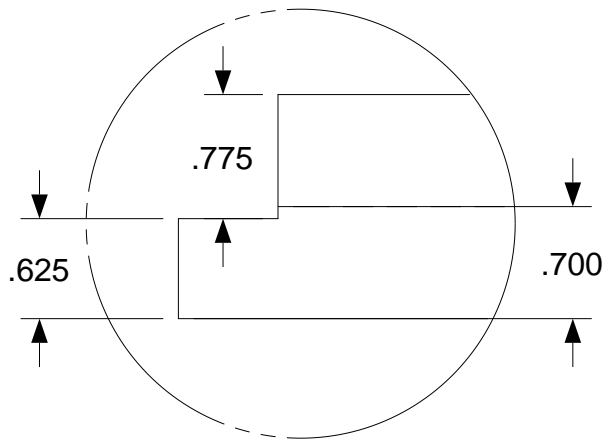
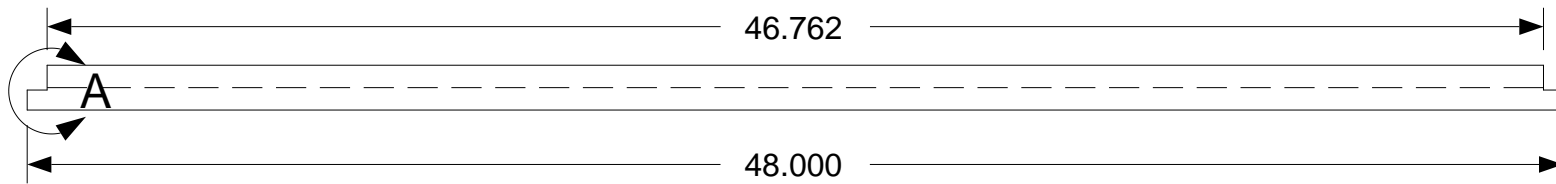

DESCRIPTION - NOTES			
unfolded view - use 16 ga. stainless - make 5			
SIZE A	DATE 1/1/08	DWG NAME inside edge reinforcing hem.icd	REV
SCALE	drawn by Larry Dobson		SHEET 2